

TRACK TRIMMING & JOINING

TRACK WITH SINGLE JOIN

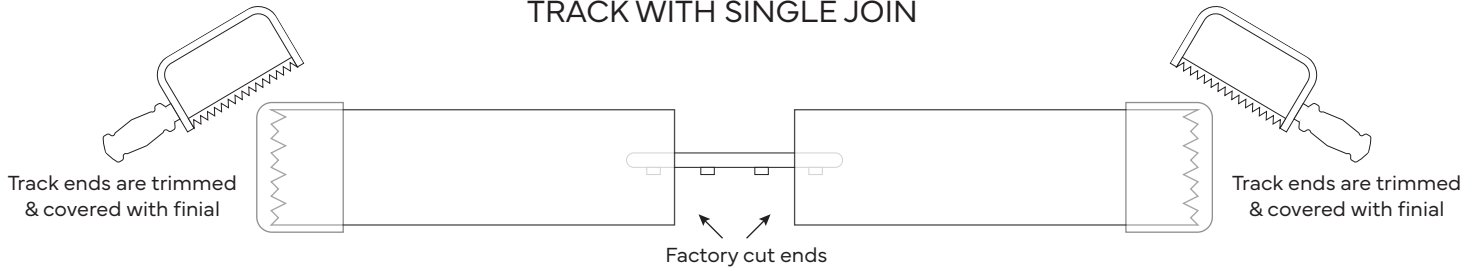

① Join factory cut ends and trim excess at track ends only

TRACK WITH MULTIPLE JOINS

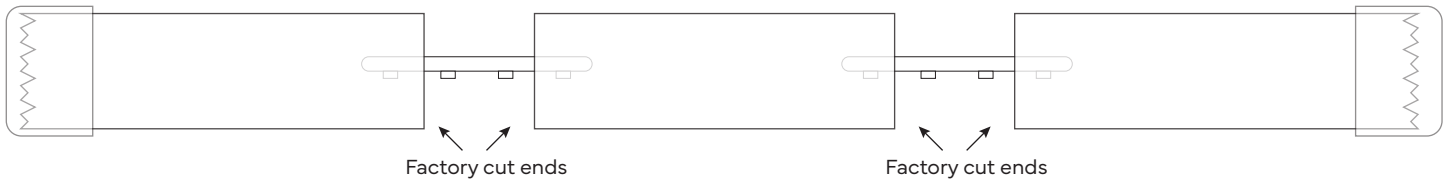

With careful installation gliders will pass over the track joins.
there is no limit to maximum track length

② Ensure joins are butted together tightly before tightening lock screws

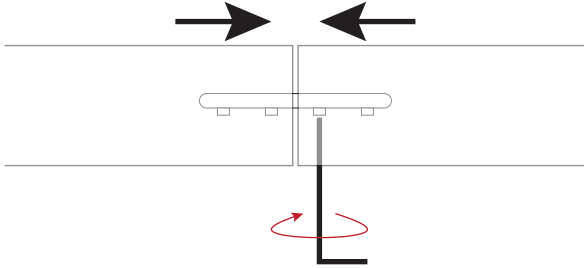

③ Place a support bracket on join (if this isn't possible, bracket needs to be as close as possible to join)

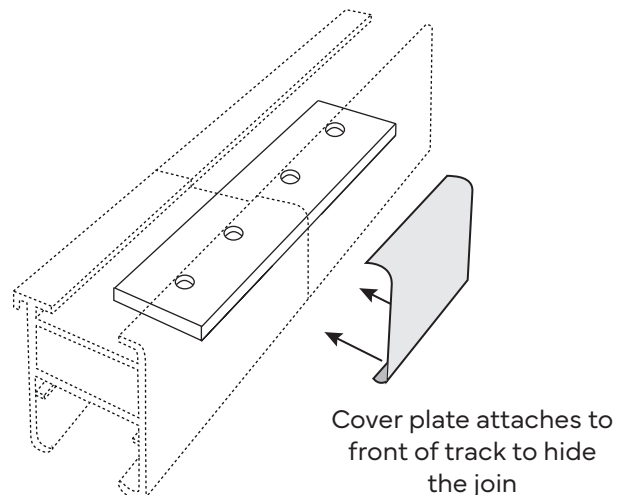
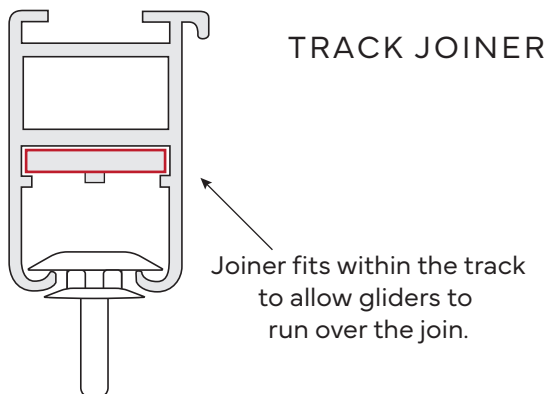
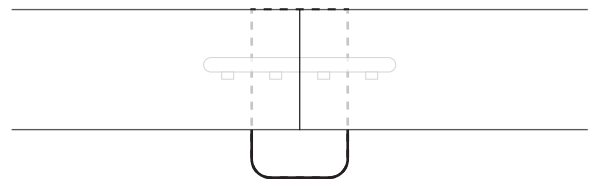

DOUBLE TRACKS

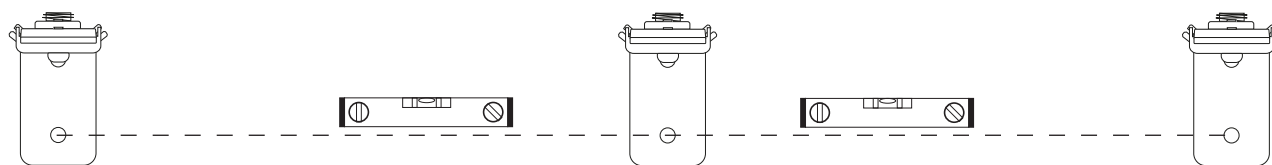

1 Ensure your markings are level and fix your brackets to the wall

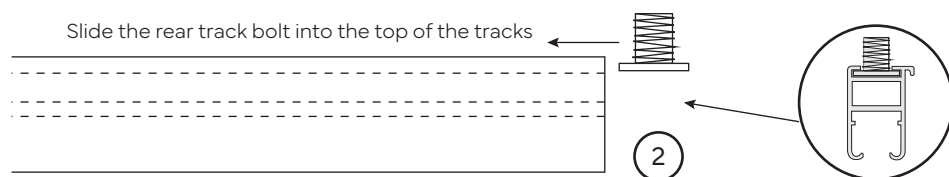

2

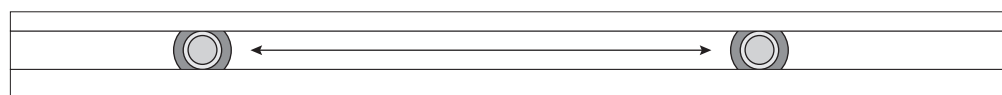

3 Slide bolts along track to match the bracket locations

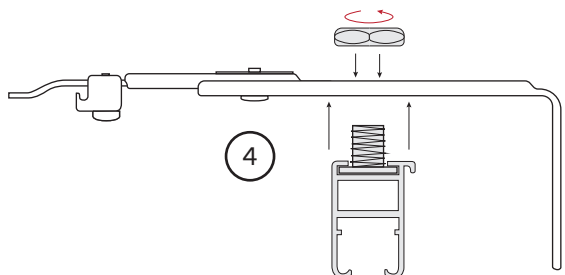

4

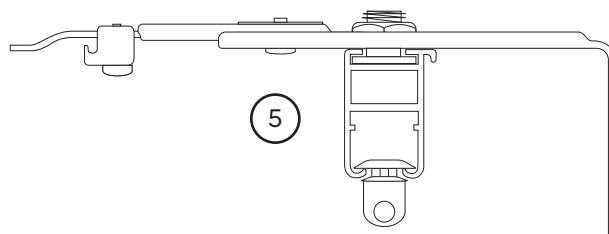

5

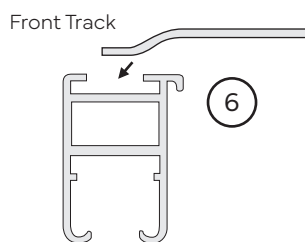

6

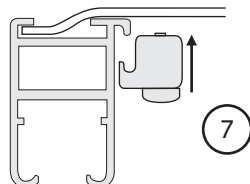

7

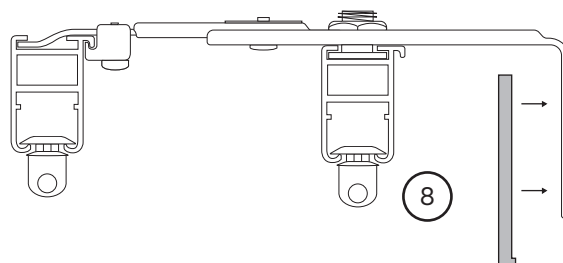

8

FOLLOW STANDARD INSTRUCTIONS FOR INSTALLING GLIDERS AND END STOPS

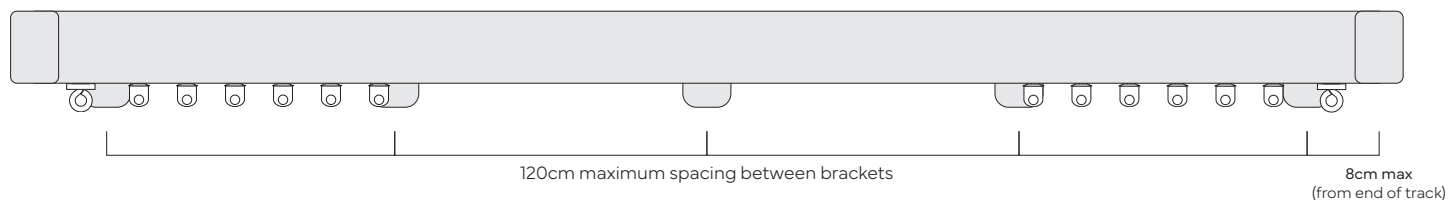

120cm maximum spacing between brackets

8cm max
(from end of track)

